

DeZignCore Ultra Luxury Vinyl Planks

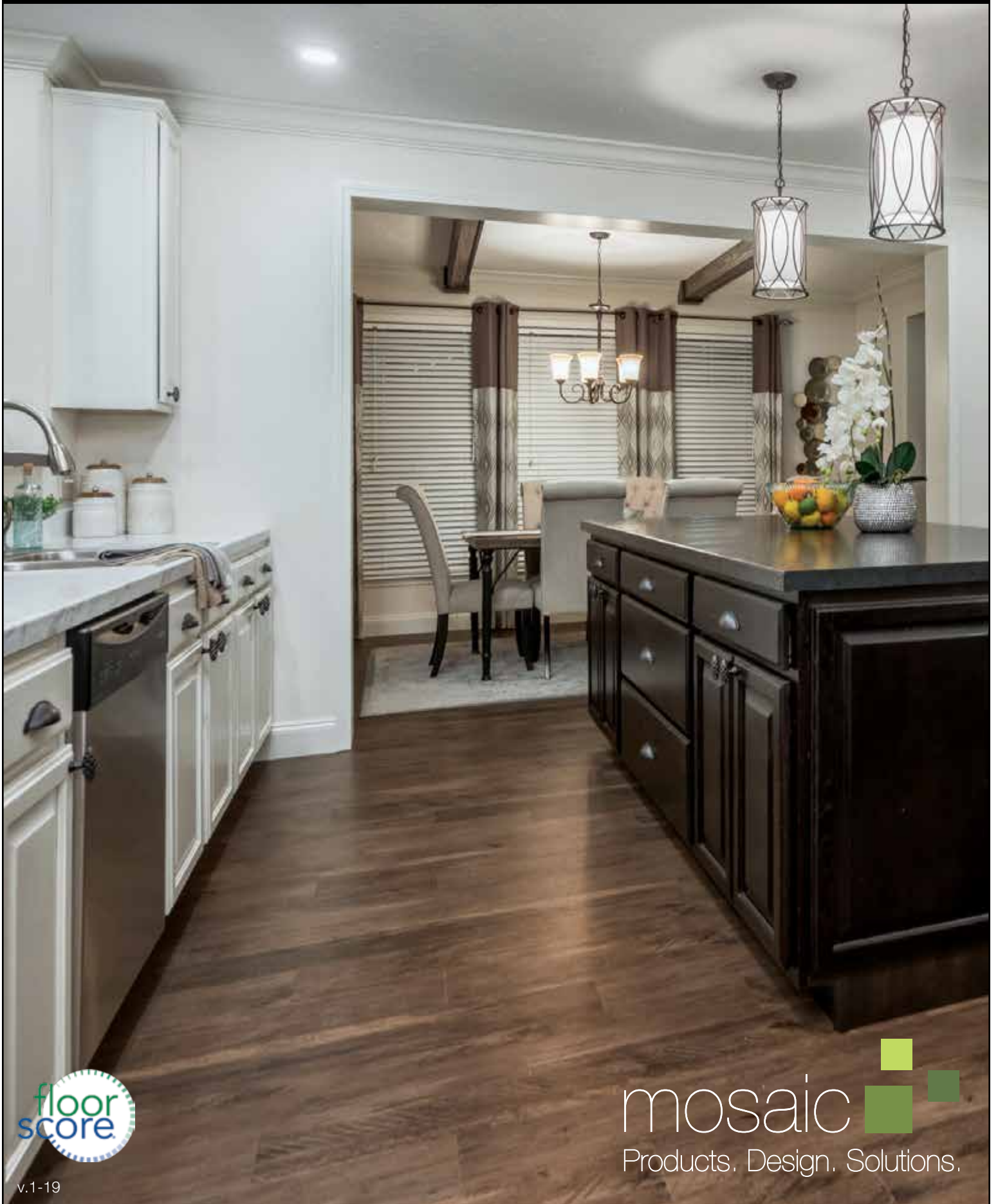

v.1-19

mosaic 
Products. Design. Solutions.

Brushed



Weathered Oak 6" x 48" x 5.5mm
DEDCU-837 \$5.23/sf



Barnwood 6" x 48" x 5.5mm
DEDCU-337 \$5.23/sf



Southern Pecan 6" x 48" x 5.5mm
DEDCU-162 \$5.23/sf



Auburn Oak 6" x 48" x 5.5mm
DEDCU-921 \$5.23/sf

Features:

- Rigid Core Technology* with EVA Backing
- Valinge Clic System
- 100% Waterproof
- Pressed Beveled Edge
- 22mil Wear Layer
- Quartz Enhanced Urethane Finish
- Will not telegraph, expand, or contract
- Lifetime Residential Warranty; 10 Year Heavy Commercial Warranty
- FloorScore® Indoor Air Quality Certified

* Rigid Core Technology – The stone polymer composite core is composed of 60% limestone and 40% vinyl resin with no wood dust or plasticizers. This allows for excellent sound-deadening properties and an 1800 PSI rating. This product is not subject to the Lacey Act.

Handscraped



Toffee 6" x 48" x 5.5mm
DEDCU-631 \$5.23/sf



Sawmill Hickory 6" x 48" x 5.5mm
DEDCU-774 \$5.23/sf



Available Trim

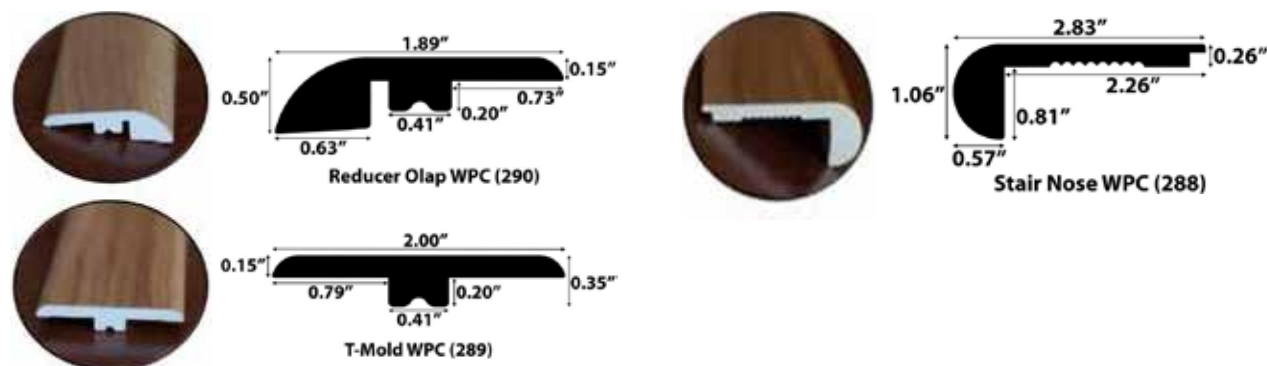

- Trim pieces have a wood polymer composite (WPC) core
- Each trim piece is 95" in length
- It is recommended to predrill holes



Installation

Before You Start

Please read all the instructions before you begin the installation. Improper installation will void warranty.

Important Notice

After installation, make sure to keep the room within a temperature range of 60°F to 80°F. Excessively high or low temperatures may cause this product to expand or contract and lead to visual defects of the floor that will not be warranted.

In cases where the flooring is in direct sunlight for much of the day, it is recommended that the planks be glued down in those spots/areas. The planks are still clicked together as per the floating installation instructions, but an approved premium luxury vinyl flooring adhesive should be used in areas as needed. Be sure to follow the adhesive manufacturer's instructions, including correct trowel size.

Avoid exposure to direct sunlight for prolonged periods, as this can cause discoloration.

For the best result, make sure to always work from 2 to 3 cartons at a time mixing the planks during the installation to ensure proper variation.

- Calculate the room surface prior to installation and plan an extra 10% of flooring for cutting waste.
- If the boxes of flooring were exposed over 2 hours to extreme temperatures (under 50°F or over 100°F) within the 12 hours before the installation, acclimation is required. In this case, keep the boards in room temperature for at least 12 hours in unopened package before you start the installation. The room temperature must be maintained consistent between 60° to 80°F before and during installation.
- For floor surfaces exceeding 4,000 ft and or lengths exceeding 60 ft, use expansion moldings.
- Inspect your subfloor before you begin. It must be clean and level to 3/16" within a 10 ft span.
- Although this floor is waterproof, it is not aimed to be used as a moisture barrier. The subfloor must be dry (max 2.5% moisture content - CM method). This product is also not to be installed in areas that have a risk of flooding such as saunas or outdoor areas. Install a moisture barrier if needed.
- If this flooring is intended to be installed over an existing wooden floor, it is recommended to repair any loose boards or squeaks before you begin the installation.
- With a floating floor you must always ensure you leave a 1/4" gap between walls and fixtures such as pipes and pillars, stairs, etc. These gaps will be covered with trim moldings after the floor is installed. Tip: When installing around pipes, drill the holes 3/4" larger than the diameter of the pipes.
- Cabinetry may be installed on top of a floating floor. However, it is recommended to leave a 1/4" gap around the perimeter.
- It is recommended to install the length direction of the planks parallel to the main light direction.
- Measure the area to be installed: The board width of the last row shall not be less than 2". If so, adjust the width of the first row to be installed. In narrow hallways, it is recommended to install the floor parallel to the length of the hall.
- Inspect each individual plank one by one before installation. No claims on surface defects will be accepted after installation. Work from multiple cartons to ensure proper variation.
- Due to the speed of sudden temperature changes, which has the potential to negatively affect this flooring, it is not recommended to install over any electrical radiant heating system. Installation over electrical radiant heating systems will not be covered by the manufacturer's warranty.

For radiant heating systems using water, ensure the radiant heat surface temperature never exceeds 81°F. Before installing over newly constructed radiant heat systems, operate the system at maximum capacity to force any residual moisture from the cementitious topping of the radiant heat system. The maximum moisture content of the screed is 1.5% (CM method). Shut down the floor heating at least 48 hours prior to installation. Make sure that the temperature in the room is at least 60°F during installation. It is recommended that the radiant heat be applied in a gradual manner after installing the floor. Refer to the radiant heat system's manufacturer recommendations for additional guidance.

Installation (cont.)

Tools and Supplies Required

- Spacers
- Rubber Mallet
- Utility Knife
- Ruler
- Pencil
- Tape Measure

Installation Method

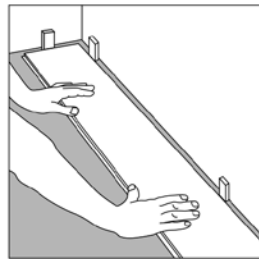

After thoroughly cleaning the subfloor, you should begin laying from left to right. Place the floorboard 1/4" from the left wall. Use spacers between the wall and the floorboard.

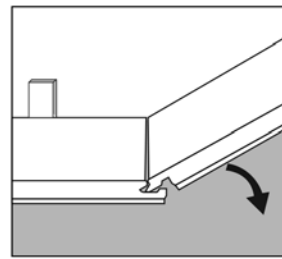

Insert the end section of the next floorboard at an angle to the first one, then lay down. Complete the first row in the same manner.

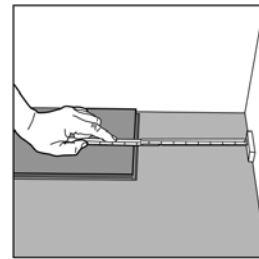

At the end of the first row, leave an expansion gap of 1/4" to the wall and measure the length of the last plank to fit.

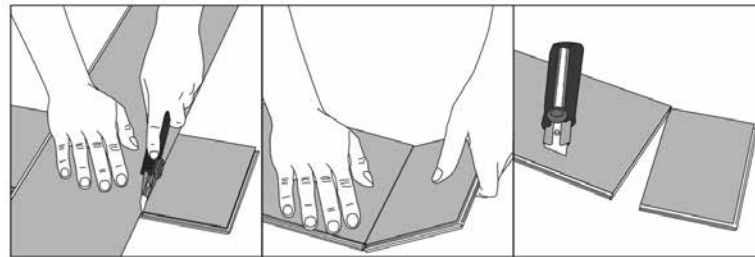

To cut the plank, use a simple utility knife and ruler, and with the top side facing up, cut heavily and several times on the same axis. The knife will not go through the surface but make a deep cut. You can then lift one half of the plank using your other hand to hold down the second placing it very close to the cut. The plank will split naturally.

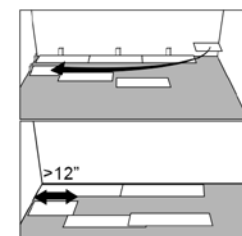

Start the second row with the leftover cut part of the last plank of the previous row. This small plank should measure at least 12". Otherwise, use another plank that should be cut in two. The end joints of each adjoining row should not be closer than 8" to each other.

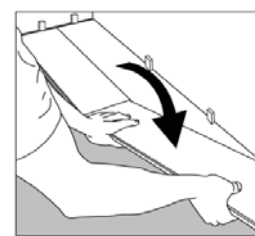

Lock the short end of the floorboard by inserting the tongue into the groove at an angle and dropping it into place. **IMPORTANT:** Make sure it is tightly locked with no gap. Then slide the floorboard towards the previously installed row until the tongue just touches the groove.

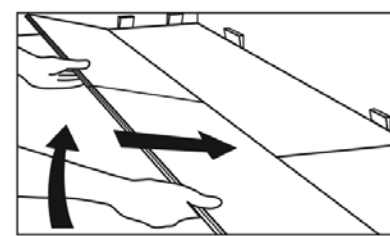

Lift both the current as well as the previous plank from this row. Position the board so that the long side of the board is close to the boards in the previous row and overlapping the groove of the boards in the previous row.

Installation (cont.)

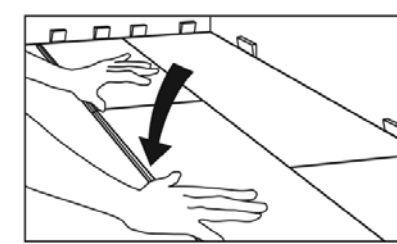

Angle up and push forwards until the boards lock together. Install the next planks as per instructions for the second row.

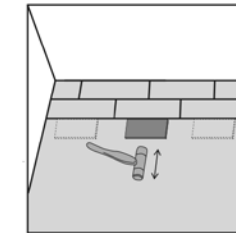

After finishing installation of the row, use scrap pieces and a small hammer or rubber mallet to gently tap the planks into the click of the previous row to make sure they are tightly clicked together and make sure there is no gap between the long side of the planks installed. **ANY GAPPING CAN COMPROMISE THE WHOLE INSTALLATION.**

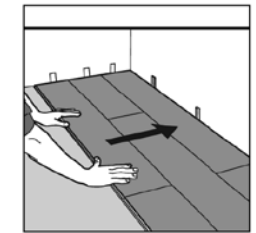

After 2-3 rows, adjust the distance to the front wall by leaving an expansion gap of 1/4". Always ensure that the end joints are staggered at least 8", both when in the same row as when from one row to the next one.

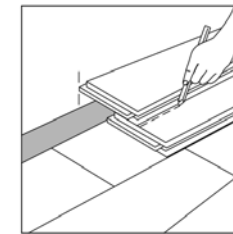

To lay the last row, position a loose board exactly on top of the last row laid. Place another board on top, with the tongue side touching the wall. Draw a line along the edge of this board to mark the first board. Cut along the edge of this line to obtain of the required width. Insert this cut board against the wall. The last row should be at least 2" wide. The spacers can then be removed.

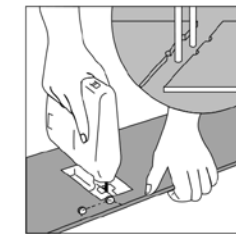

Holes for pipes: Measure the diameter of the pipe and drill a hole that is 7/8" larger. Saw off a piece as shown in the figure and lay the board in place on the floor. Then lay the sawed-off piece in place.

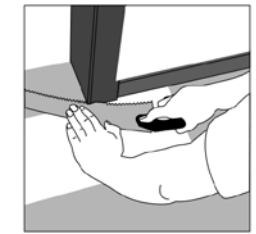

Door molding and skirting: Lay a board (with the decorative side down) next to the door molding and as shown in the figure. Then slide the floorboard under molding.

Care & Maintenance

- Sweep or vacuum daily using soft bristle attachments.
- Clean up spills and excessive liquids immediately.
- Damp mop as needed and use cleaners recommended with no-wax or oil.
- Protect floor from constant direct sunlight. Close blinds or drapes during peak sunlight hours.
- Use proper floor protection devices such as felt protectors under furniture.
- Use a mat at entrance ways (please ensure the mat doesn't have rubber backing).
- Do not use abrasive cleaners, bleach, or wax to maintain the floor.
- Do not drag or slide heavy objects across the floor.



mosaic 
Products. Design. Solutions.

Alexandria, VA | Chantilly, VA | Fairfax, VA | Richmond, VA | Virginia Beach, VA
North Bethesda, MD* | Owings Mills, MD* | Greensboro, NC | Raleigh, NC

www.mosaictileco.com



Noted (*) locations are
100% wind powered!
All locations support
renewable power sources.

